



Multifunctional storage unit in blockboard and solid wood, with double doors opening to 180°. Designed as a wine-storage unit, inside there are grids and containers for bottles and glasses, with the possibility to insert small electrical appliances (Jumbo version). The doors' inner structure allows to organise glasses and accessories. The inside is illuminated by LED strips along the inner side, activated automatically via sensors when the doors are opened.

SMALL DOOR ON THE LEFT AND BIG DOOR ON THE RIGHT, BUT EXCHANGEABLE UPON REQUEST

FOR JUMBO VERSION (with the possibility to insert small electrical appliances such as fridge, microwave oven, wine cellar): maximum size for built-in appliances W.56 D.55 H.45 cm, but the space can also be customized. It is necessary to supply the technical data sheet of the chosen appliance for our approval.

CODE	SIZE	HANDLE AND PROFILE	A1	A2	A4
CAMBUSA WINE	W.127/254,6 x D.60,2 x H.201	B2	■	■	■
		B3	■	■	■
CAMBUSA WINE JUMBO	W.127/254,6 x D.78,7 x H.201	B2	■	■	■
		B3	■	■	■

**AVAILABLE FINISHES:**

- A1:** walnut without knots, walnut with knots
- A2:** oak without knots, oak with knots, cherry
- A4:** oak without knots pigmented: white milk, total black  
oak with knots pigmented: white milk, total black
- B2:** lacquered iron: iron dust, RAL (only selected colours)
- B3:** lacquered iron matt brushed effect: aged bronze, stainless steel, titanium

# CAMBUSA WINE /JUMBO

CAMBUSA WINE JUMBO

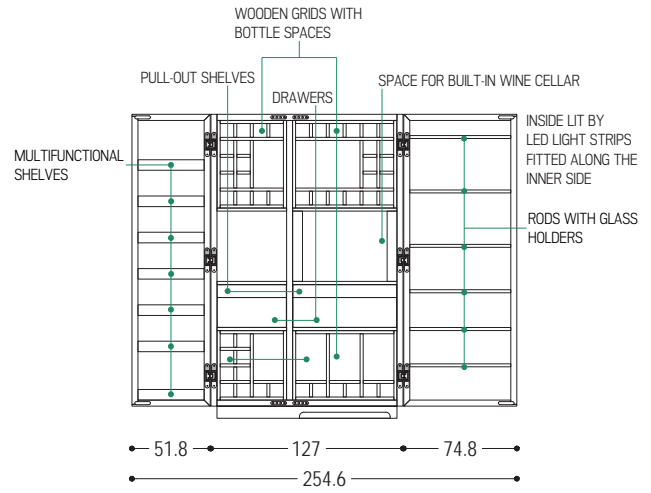
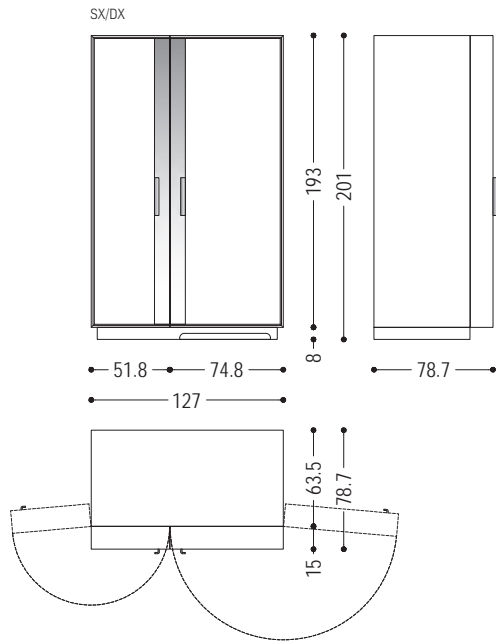

CAMBUSA WINE

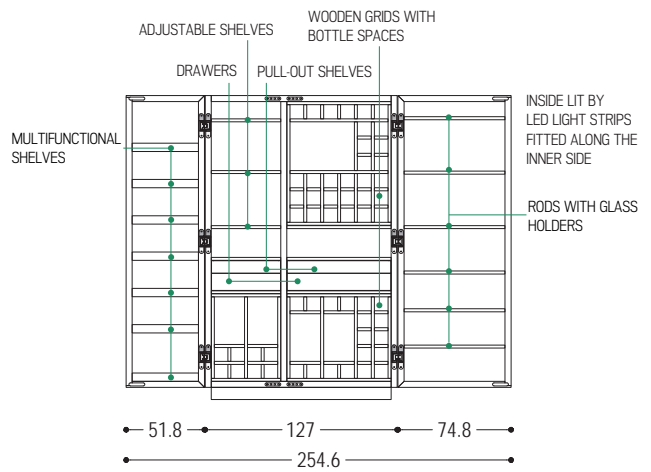
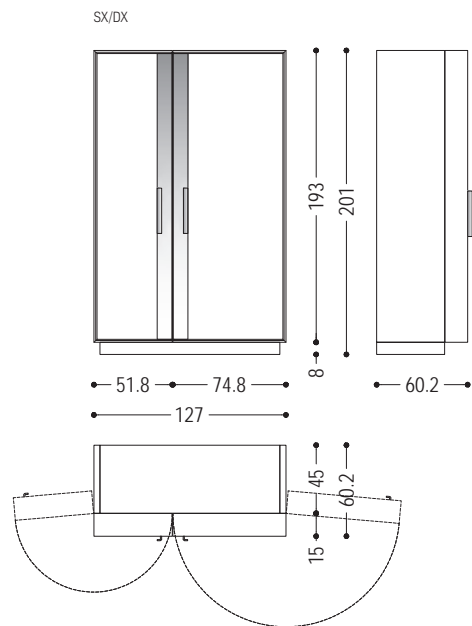

# CAMBUSA WINE /JUMBO | AVAILABLE FINISHES

## WOOD

A1

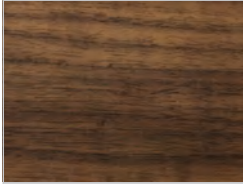

walnut without knots



walnut with knots

A2

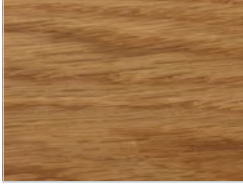

oak without knots



oak with knots

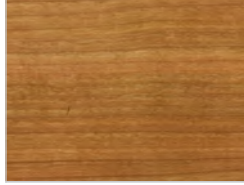

cherry

A4



oak without knots pigmented:  
white milk



oak without knots pigmented:  
total black



oak with knots pigmented:  
white milk



oak with knots pigmented:  
total black

## IRON

B2

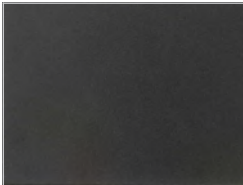

lacquered iron:  
iron dust

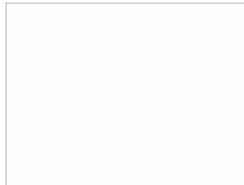

ferro laccato:  
RAL - 1013\_OYSTER WHITE



ferro laccato:  
RAL - 3020\_TRAFFIC RED

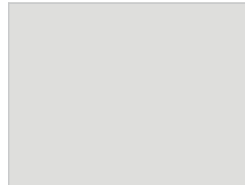

ferro laccato:  
RAL - 7035\_LIGHT GREY



ferro laccato:  
RAL - 7037\_DUSTY GREY

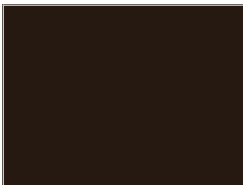

ferro laccato:  
RAL - 8019\_GREY BROWN

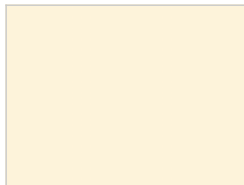

ferro laccato:  
RAL - 9001\_CREAM WHITE

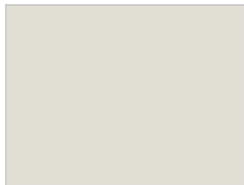

ferro laccato:  
RAL - 9002\_GREY WHITE

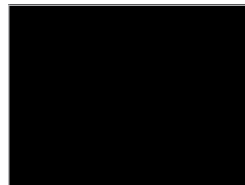

ferro laccato:  
RAL - 9005\_JET BLACK

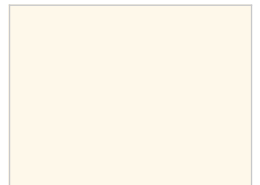

ferro laccato:  
RAL - 9010\_PURE WHITE



ferro laccato:  
RAL - 9016\_TRAFFIC WHITE

# CAMBUSA WINE /JUMBO | AVAILABLE FINISHES

---

B3



lacquered iron, matt brushed effect:  
aged bronze



lacquered iron, matt brushed effect:  
stainless steel



lacquered iron, matt brushed effect:  
titanium