



Round small table with solid wood top made of glued lists, combined with an iron base. Available in different sizes, with possibility of stacking one over the other.

CODE	SIZE	BASE	A1	A2	A4
KOHI-WOOD1	Ø 65 x H.22	B2	■	■	■
		B3	■	■	■
KOHI-WOOD2	Ø 65 x H.32	B2	■	■	■
		B3	■	■	■
KOHI-WOOD3	Ø 95 x H.22	B2	■	■	■
		B3	■	■	■
KOHI-WOOD4	Ø 95 x H.32	B2	■	■	■
		B3	■	■	■



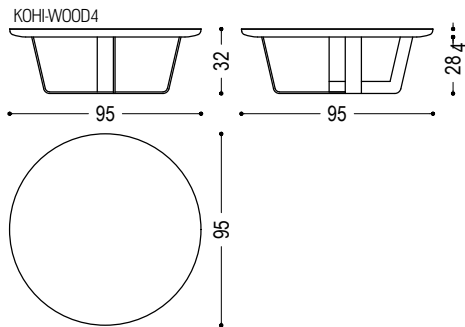
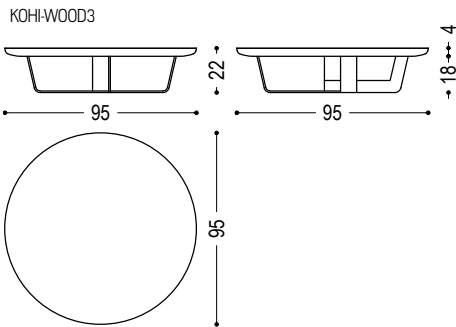
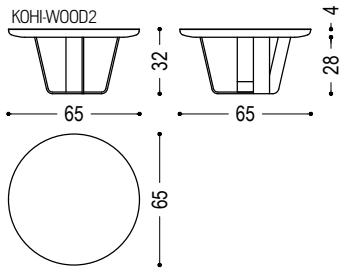
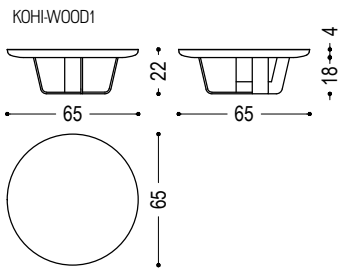

AVAILABLE FINISHES

- A1: walnut without knots, walnut with knots
- A2: oak without knots, oak with knots, cherry
- A4: oak without knots pigmented: white milk, total black
- B2: lacquered iron: irondust, RAL (only selected colours)
- B3: lacquered iron matt brushed effect: aged bronze, stainless steel, titanium



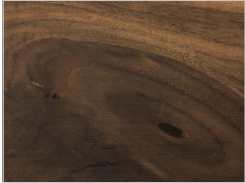

# KOHI WOOD | AVAILABLE FINISHES

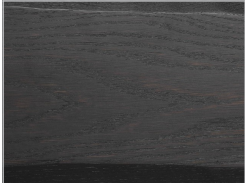
## WOOD

A1			
	walnut without knots	walnut with knots	
A2			
	oak without knots	oak with knots	cherry
A4			
	oak without knots pigmented: white milk	oak without knots pigmented: total black	

## IRON

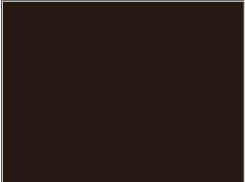
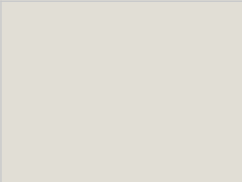
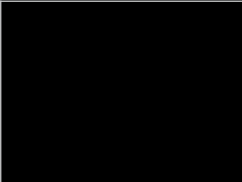
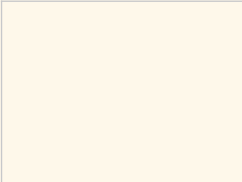
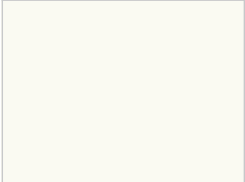
B2					
	lacquered iron: iron dust	ferro laccato: RAL - 1013_OYSTER WHITE	ferro laccato: RAL - 3020_TRAFFIC RED	ferro laccato: RAL - 7035_LIGHT GREY	ferro laccato: RAL - 7037_DUSTY GREY
					
	ferro laccato: RAL - 8019_GREY BROWN	ferro laccato: RAL - 9001_CREAM WHITE	ferro laccato: RAL - 9002_GREY WHITE	ferro laccato: RAL - 9005_JET BLACK	ferro laccato: RAL - 9010_PURE WHITE
					
	ferro laccato: RAL - 9016_TRAFFIC WHITE				

# KOHI WOOD | AVAILABLE FINISHES

---

B3



lacquered iron, matt brushed effect:  
aged bronze



lacquered iron, matt brushed effect:  
stainless steel



lacquered iron, matt brushed effect:  
titanium